

## Part I: General Conditions

### General Information

Name of Municipality or Organization:  State: 

EPA NPDES Permit Number (if applicable): 

### Primary MS4 Program Manager Contact Information

Name:  Title: 

Street Address Line 1: 

Street Address Line 2: 

City:  State:  Zip Code: 

Email:  Phone Number: 

Fax Number: 

### Other Information

Stormwater Management Program (SWMP) Location (web address or physical location, if already completed): 

### Eligibility Determination

Endangered Species Act (ESA) Determination Complete? 

Eligibility Criteria (check all that apply): ☐ A ☒ B ☐ C

National Historic Preservation Act (NHPA) Determination Complete? 

Eligibility Criteria (check all that apply): ☒ A ☐ B ☐ C

☒ Check the box if your municipality or organization was covered under the 2003 MS4 General Permit

### MS4 Infrastructure (if covered under the 2003 permit)

Estimated Percent of Outfall Map Complete?  If 100% of 2003 requirements not met, enter an estimated date of completion (MM/DD/YY): 

Web address where MS4 map is published: 

If outfall map is unavailable on the internet an electronic or paper copy of the outfall map must be included with NOI submission (see section V for submission options)

### Regulatory Authorities (if covered under the 2003 permit)

Illicit Discharge Detection and Elimination (IDDE) Authority Adopted?  Effective Date or Estimated Date of Adoption (MM/DD/YY): 

Construction/Erosion and Sediment Control (ESC) Authority Adopted?  Effective Date or Estimated Date of Adoption (MM/DD/YY): 

Post- Construction Stormwater Management Adopted?  Effective Date or Estimated Date of Adoption (MM/DD/YY):



Waterbody that receives flow from the MS4 and segment ID if applicable	Number of outfalls into receiving water segment	Other pollutant(s) causing impairments								
		Chloride	Chlorophyll-a	Dissolved Oxygen/DO Saturation	Nitrogen	Oil & Grease/ PAH	Phosphorus	Solids/ TSS/ Turbidity	E. coli	Enterococcus
		<input type="checkbox"/>	<input type="checkbox"/>	<input type="checkbox"/>	<input type="checkbox"/>	<input type="checkbox"/>	<input type="checkbox"/>	<input type="checkbox"/>	<input type="checkbox"/>	<input type="checkbox"/>
		<input type="checkbox"/>	<input type="checkbox"/>	<input type="checkbox"/>	<input type="checkbox"/>	<input type="checkbox"/>	<input type="checkbox"/>	<input type="checkbox"/>	<input type="checkbox"/>	<input type="checkbox"/>
		<input type="checkbox"/>	<input type="checkbox"/>	<input type="checkbox"/>	<input type="checkbox"/>	<input type="checkbox"/>	<input type="checkbox"/>	<input type="checkbox"/>	<input type="checkbox"/>	<input type="checkbox"/>
		<input type="checkbox"/>	<input type="checkbox"/>	<input type="checkbox"/>	<input type="checkbox"/>	<input type="checkbox"/>	<input type="checkbox"/>	<input type="checkbox"/>	<input type="checkbox"/>	<input type="checkbox"/>
		<input type="checkbox"/>	<input type="checkbox"/>	<input type="checkbox"/>	<input type="checkbox"/>	<input type="checkbox"/>	<input type="checkbox"/>	<input type="checkbox"/>	<input type="checkbox"/>	<input type="checkbox"/>
		<input type="checkbox"/>	<input type="checkbox"/>	<input type="checkbox"/>	<input type="checkbox"/>	<input type="checkbox"/>	<input type="checkbox"/>	<input type="checkbox"/>	<input type="checkbox"/>	<input type="checkbox"/>
		<input type="checkbox"/>	<input type="checkbox"/>	<input type="checkbox"/>	<input type="checkbox"/>	<input type="checkbox"/>	<input type="checkbox"/>	<input type="checkbox"/>	<input type="checkbox"/>	<input type="checkbox"/>
		<input type="checkbox"/>	<input type="checkbox"/>	<input type="checkbox"/>	<input type="checkbox"/>	<input type="checkbox"/>	<input type="checkbox"/>	<input type="checkbox"/>	<input type="checkbox"/>	<input type="checkbox"/>
		<input type="checkbox"/>	<input type="checkbox"/>	<input type="checkbox"/>	<input type="checkbox"/>	<input type="checkbox"/>	<input type="checkbox"/>	<input type="checkbox"/>	<input type="checkbox"/>	<input type="checkbox"/>
		<input type="checkbox"/>	<input type="checkbox"/>	<input type="checkbox"/>	<input type="checkbox"/>	<input type="checkbox"/>	<input type="checkbox"/>	<input type="checkbox"/>	<input type="checkbox"/>	<input type="checkbox"/>
		<input type="checkbox"/>	<input type="checkbox"/>	<input type="checkbox"/>	<input type="checkbox"/>	<input type="checkbox"/>	<input type="checkbox"/>	<input type="checkbox"/>	<input type="checkbox"/>	<input type="checkbox"/>
		<input type="checkbox"/>	<input type="checkbox"/>	<input type="checkbox"/>	<input type="checkbox"/>	<input type="checkbox"/>	<input type="checkbox"/>	<input type="checkbox"/>	<input type="checkbox"/>	<input type="checkbox"/>
		<input type="checkbox"/>	<input type="checkbox"/>	<input type="checkbox"/>	<input type="checkbox"/>	<input type="checkbox"/>	<input type="checkbox"/>	<input type="checkbox"/>	<input type="checkbox"/>	<input type="checkbox"/>
		<input type="checkbox"/>	<input type="checkbox"/>	<input type="checkbox"/>	<input type="checkbox"/>	<input type="checkbox"/>	<input type="checkbox"/>	<input type="checkbox"/>	<input type="checkbox"/>	<input type="checkbox"/>
		<input type="checkbox"/>	<input type="checkbox"/>	<input type="checkbox"/>	<input type="checkbox"/>	<input type="checkbox"/>	<input type="checkbox"/>	<input type="checkbox"/>	<input type="checkbox"/>	<input type="checkbox"/>
		<input type="checkbox"/>	<input type="checkbox"/>	<input type="checkbox"/>	<input type="checkbox"/>	<input type="checkbox"/>	<input type="checkbox"/>	<input type="checkbox"/>	<input type="checkbox"/>	<input type="checkbox"/>
		<input type="checkbox"/>	<input type="checkbox"/>	<input type="checkbox"/>	<input type="checkbox"/>	<input type="checkbox"/>	<input type="checkbox"/>	<input type="checkbox"/>	<input type="checkbox"/>	<input type="checkbox"/>
		<input type="checkbox"/>	<input type="checkbox"/>	<input type="checkbox"/>	<input type="checkbox"/>	<input type="checkbox"/>	<input type="checkbox"/>	<input type="checkbox"/>	<input type="checkbox"/>	<input type="checkbox"/>
		<input type="checkbox"/>	<input type="checkbox"/>	<input type="checkbox"/>	<input type="checkbox"/>	<input type="checkbox"/>	<input type="checkbox"/>	<input type="checkbox"/>	<input type="checkbox"/>	<input type="checkbox"/>
		<input type="checkbox"/>	<input type="checkbox"/>	<input type="checkbox"/>	<input type="checkbox"/>	<input type="checkbox"/>	<input type="checkbox"/>	<input type="checkbox"/>	<input type="checkbox"/>	<input type="checkbox"/>
		<input type="checkbox"/>	<input type="checkbox"/>	<input type="checkbox"/>	<input type="checkbox"/>	<input type="checkbox"/>	<input type="checkbox"/>	<input type="checkbox"/>	<input type="checkbox"/>	<input type="checkbox"/>
		<input type="checkbox"/>	<input type="checkbox"/>	<input type="checkbox"/>	<input type="checkbox"/>	<input type="checkbox"/>	<input type="checkbox"/>	<input type="checkbox"/>	<input type="checkbox"/>	<input type="checkbox"/>
		<input type="checkbox"/>	<input type="checkbox"/>	<input type="checkbox"/>	<input type="checkbox"/>	<input type="checkbox"/>	<input type="checkbox"/>	<input type="checkbox"/>	<input type="checkbox"/>	<input type="checkbox"/>
		<input type="checkbox"/>	<input type="checkbox"/>	<input type="checkbox"/>	<input type="checkbox"/>	<input type="checkbox"/>	<input type="checkbox"/>	<input type="checkbox"/>	<input type="checkbox"/>	<input type="checkbox"/>
		<input type="checkbox"/>	<input type="checkbox"/>	<input type="checkbox"/>	<input type="checkbox"/>	<input type="checkbox"/>	<input type="checkbox"/>	<input type="checkbox"/>	<input type="checkbox"/>	<input type="checkbox"/>
		<input type="checkbox"/>	<input type="checkbox"/>	<input type="checkbox"/>	<input type="checkbox"/>	<input type="checkbox"/>	<input type="checkbox"/>	<input type="checkbox"/>	<input type="checkbox"/>	<input type="checkbox"/>
		<input type="checkbox"/>	<input type="checkbox"/>	<input type="checkbox"/>	<input type="checkbox"/>	<input type="checkbox"/>	<input type="checkbox"/>	<input type="checkbox"/>	<input type="checkbox"/>	<input type="checkbox"/>
		<input type="checkbox"/>	<input type="checkbox"/>	<input type="checkbox"/>	<input type="checkbox"/>	<input type="checkbox"/>	<input type="checkbox"/>	<input type="checkbox"/>	<input type="checkbox"/>	<input type="checkbox"/>
		<input type="checkbox"/>	<input type="checkbox"/>	<input type="checkbox"/>	<input type="checkbox"/>	<input type="checkbox"/>	<input type="checkbox"/>	<input type="checkbox"/>	<input type="checkbox"/>	<input type="checkbox"/>
		<input type="checkbox"/>	<input type="checkbox"/>	<input type="checkbox"/>	<input type="checkbox"/>	<input type="checkbox"/>	<input type="checkbox"/>	<input type="checkbox"/>	<input type="checkbox"/>	<input type="checkbox"/>
		<input type="checkbox"/>	<input type="checkbox"/>	<input type="checkbox"/>	<input type="checkbox"/>	<input type="checkbox"/>	<input type="checkbox"/>	<input type="checkbox"/>	<input type="checkbox"/>	<input type="checkbox"/>
		<input type="checkbox"/>	<input type="checkbox"/>	<input type="checkbox"/>	<input type="checkbox"/>	<input type="checkbox"/>	<input type="checkbox"/>	<input type="checkbox"/>	<input type="checkbox"/>	<input type="checkbox"/>
		<input type="checkbox"/>	<input type="checkbox"/>	<input type="checkbox"/>	<input type="checkbox"/>	<input type="checkbox"/>	<input type="checkbox"/>	<input type="checkbox"/>	<input type="checkbox"/>	<input type="checkbox"/>
		<input type="checkbox"/>	<input type="checkbox"/>	<input type="checkbox"/>	<input type="checkbox"/>	<input type="checkbox"/>	<input type="checkbox"/>	<input type="checkbox"/>	<input type="checkbox"/>	<input type="checkbox"/>
		<input type="checkbox"/>	<input type="checkbox"/>	<input type="checkbox"/>	<input type="checkbox"/>	<input type="checkbox"/>	<input type="checkbox"/>	<input type="checkbox"/>	<input type="checkbox"/>	<input type="checkbox"/>
		<input type="checkbox"/>	<input type="checkbox"/>	<input type="checkbox"/>	<input type="checkbox"/>	<input type="checkbox"/>	<input type="checkbox"/>	<input type="checkbox"/>	<input type="checkbox"/>	<input type="checkbox"/>
		<input type="checkbox"/>	<input type="checkbox"/>	<input type="checkbox"/>	<input type="checkbox"/>	<input type="checkbox"/>	<input type="checkbox"/>	<input type="checkbox"/>	<input type="checkbox"/>	<input type="checkbox"/>
		<input type="checkbox"/>	<input type="checkbox"/>	<input type="checkbox"/>	<input type="checkbox"/>	<input type="checkbox"/>	<input type="checkbox"/>	<input type="checkbox"/>	<input type="checkbox"/>	<input type="checkbox"/>
		<input type="checkbox"/>	<input type="checkbox"/>	<input type="checkbox"/>	<input type="checkbox"/>	<input type="checkbox"/>	<input type="checkbox"/>	<input type="checkbox"/>	<input type="checkbox"/>	<input type="checkbox"/>
		<input type="checkbox"/>	<input type="checkbox"/>	<input type="checkbox"/>	<input type="checkbox"/>	<input type="checkbox"/>	<input type="checkbox"/>	<input type="checkbox"/>	<input type="checkbox"/>	<input type="checkbox"/>
		<input type="checkbox"/>	<input type="checkbox"/>	<input type="checkbox"/>	<input type="checkbox"/>	<input type="checkbox"/>	<input type="checkbox"/>	<input type="checkbox"/>	<input type="checkbox"/>	<input type="checkbox"/>
		<input type="checkbox"/>	<input type="checkbox"/>	<input type="checkbox"/>	<input type="checkbox"/>	<input type="checkbox"/>	<input type="checkbox"/>	<input type="checkbox"/>	<input type="checkbox"/>	<input type="checkbox"/>
		<input type="checkbox"/>	<input type="checkbox"/>	<input type="checkbox"/>	<input type="checkbox"/>	<input type="checkbox"/>	<input type="checkbox"/>	<input type="checkbox"/>	<input type="checkbox"/>	<input type="checkbox"/>
		<input type="checkbox"/>	<input type="checkbox"/>	<input type="checkbox"/>	<input type="checkbox"/>	<input type="checkbox"/>	<input type="checkbox"/>	<input type="checkbox"/>	<input type="checkbox"/>	<input type="checkbox"/>
		<input type="checkbox"/>	<input type="checkbox"/>	<input type="checkbox"/>	<input type="checkbox"/>	<input type="checkbox"/>	<input type="checkbox"/>	<input type="checkbox"/>	<input type="checkbox"/>	<input type="checkbox"/>
		<input type="checkbox"/>	<input type="checkbox"/>	<input type="checkbox"/>	<input type="checkbox"/>	<input type="checkbox"/>	<input type="checkbox"/>	<input type="checkbox"/>	<input type="checkbox"/>	<input type="checkbox"/>
		<input type="checkbox"/>	<input type="checkbox"/>	<input type="checkbox"/>	<input type="checkbox"/>	<input type="checkbox"/>	<input type="checkbox"/>	<input type="checkbox"/>	<input type="checkbox"/>	<input type="checkbox"/>
		<input type="checkbox"/>	<input type="checkbox"/>	<input type="checkbox"/>	<input type="checkbox"/>	<input type="checkbox"/>	<input type="checkbox"/>	<input type="checkbox"/>	<input type="checkbox"/>	<input type="checkbox"/>
		<input type="checkbox"/>	<input type="checkbox"/>	<input type="checkbox"/>	<input type="checkbox"/>	<input type="checkbox"/>	<input type="checkbox"/>	<input type="checkbox"/>	<input type="checkbox"/>	<input type="checkbox"/>
		<input type="checkbox"/>	<input type="checkbox"/>	<input type="checkbox"/>	<input type="checkbox"/>	<input type="checkbox"/>	<input type="checkbox"/>	<input type="checkbox"/>	<input type="checkbox"/>	<input type="checkbox"/>
		<input type="checkbox"/>	<input type="checkbox"/>	<input type="checkbox"/>	<input type="checkbox"/>	<input type="checkbox"/>	<input type="checkbox"/>	<input type="checkbox"/>	<input type="checkbox"/>	<input type="checkbox"/>
		<input type="checkbox"/>	<input type="checkbox"/>	<input type="checkbox"/>	<input type="checkbox"/>	<input type="checkbox"/>	<input type="checkbox"/>	<input type="checkbox"/>	<input type="checkbox"/>	<input type="checkbox"/>
		<input type="checkbox"/>	<input type="checkbox"/>	<input type="checkbox"/>	<input type="checkbox"/>	<input type="checkbox"/>	<input type="checkbox"/>	<input type="checkbox"/>	<input type="checkbox"/>	<input type="checkbox"/>
		<input type="checkbox"/>	<input type="checkbox"/>	<input type="checkbox"/>	<input type="checkbox"/>	<input type="checkbox"/>	<input type="checkbox"/>	<input type="checkbox"/>	<input type="checkbox"/>	<input type="checkbox"/>
		<input type="checkbox"/>	<input type="checkbox"/>	<input type="checkbox"/>	<input type="checkbox"/>	<input type="checkbox"/>	<input type="checkbox"/>	<input type="checkbox"/>	<input type="checkbox"/>	<input type="checkbox"/>
		<input type="checkbox"/>	<input type="checkbox"/>	<input type="checkbox"/>	<input type="checkbox"/>	<input type="checkbox"/>	<input type="checkbox"/>	<input type="checkbox"/>	<input type="checkbox"/>	<input type="checkbox"/>
		<input type="checkbox"/>	<input type="checkbox"/>	<input type="checkbox"/>	<input type="checkbox"/>	<input type="checkbox"/>	<input type="checkbox"/>	<input type="checkbox"/>	<input type="checkbox"/>	<input type="checkbox"/>
		<input type="checkbox"/>	<input type="checkbox"/>	<input type="checkbox"/>	<input type="checkbox"/>	<input type="checkbox"/>	<input type="checkbox"/>	<input type="checkbox"/>	<input type="checkbox"/>	<input type="checkbox"/>
		<input type="checkbox"/>	<input type="checkbox"/>	<input type="checkbox"/>	<input type="checkbox"/>	<input type="checkbox"/>	<input type="checkbox"/>	<input type="checkbox"/>	<input type="checkbox"/>	<input type="checkbox"/>
		<input type="checkbox"/>	<input type="checkbox"/>	<input type="checkbox"/>	<input type="checkbox"/>	<input type="checkbox"/>	<input type="checkbox"/>	<input type="checkbox"/>	<input type="checkbox"/>	<input type="checkbox"/>
		<input type="checkbox"/>	<input type="checkbox"/>	<input type="checkbox"/>	<input type="checkbox"/>	<input type="checkbox"/>	<input type="checkbox"/>	<input type="checkbox"/>	<input type="checkbox"/>	<input type="checkbox"/>
		<input type="checkbox"/>	<input type="checkbox"/>	<input type="checkbox"/>	<input type="checkbox"/>	<input type="checkbox"/>	<input type="checkbox"/>	<input type="checkbox"/>	<input type="checkbox"/>	<input type="checkbox"/>
		<input type="checkbox"/>	<input type="checkbox"/>	<input type="checkbox"/>	<input type="checkbox"/>	<input type="checkbox"/>	<input type="checkbox"/>	<input type="checkbox"/>	<input type="checkbox"/>	<input type="checkbox"/>
		<input type="checkbox"/>	<input type="checkbox"/>	<input type="checkbox"/>	<input type="checkbox"/>	<input type="checkbox"/>	<input type="checkbox"/>	<input type="checkbox"/>	<input type="checkbox"/>	<input type="checkbox"/>
		<input type="checkbox"/>	<input type="checkbox"/>	<input type="checkbox"/>	<input type="checkbox"/>	<input type="checkbox"/>	<input type="checkbox"/>	<input type="checkbox"/>	<input type="checkbox"/>	<input type="checkbox"/>
		<input type="checkbox"/>	<input type="checkbox"/>	<input type="checkbox"/>	<input type="checkbox"/>	<input type="checkbox"/>	<input type="checkbox"/>	<input type="checkbox"/>	<input type="checkbox"/>	<input type="checkbox"/>
		<input type="checkbox"/>	<input type="checkbox"/>	<input type="checkbox"/>	<input type="checkbox"/>	<input type="checkbox"/>	<input type="checkbox"/>	<input type="checkbox"/>	<input type="checkbox"/>	<input type="checkbox"/>
		<input type="checkbox"/>	<input type="checkbox"/>	<input type="checkbox"/>	<input type="checkbox"/>	<input type="checkbox"/>	<input type="checkbox"/>	<input type="checkbox"/>	<input type="checkbox"/>	<input type="checkbox"/>
		<input type="checkbox"/>	<input type="checkbox"/>	<input type="checkbox"/>	<input type="checkbox"/>	<input type="checkbox"/>	<input type="checkbox"/>	<input type="checkbox"/>	<input type="checkbox"/>	<input type="checkbox"/>
		<input type="checkbox"/>	<input type="checkbox"/>	<input type="checkbox"/>	<input type="checkbox"/>	<input type="checkbox"/>	<input type="checkbox"/>	<input type="checkbox"/>	<input type="checkbox"/>	<input type="checkbox"/>
		<input type="checkbox"/>	<input type="checkbox"/>	<input type="checkbox"/>	<input type="checkbox"/>	<input type="checkbox"/>	<input type="checkbox"/>	<input type="checkbox"/>	<input type="checkbox"/>	<input type="checkbox"/>
		<input type="checkbox"/>	<input type="checkbox"/>	<input type="checkbox"/>	<input type="checkbox"/>	<input type="checkbox"/>	<input type="checkbox"/>	<input type="checkbox"/>	<input type="checkbox"/>	<input type="checkbox"/>
		<input type="checkbox"/>	<input type="checkbox"/>	<input type="checkbox"/>	<input type="checkbox"/>	<input type="checkbox"/>	<input type="checkbox"/>	<input type="checkbox"/>	<input type="checkbox"/>	<input type="checkbox"/>
		<input type="checkbox"/>	<input type="checkbox"/>	<input type="checkbox"/>	<input type="checkbox"/>	<input type="checkbox"/>	<input type="checkbox"/>	<input type="checkbox"/>	<input type="checkbox"/>	<input type="checkbox"/>
		<input type="checkbox"/>	<input type="checkbox"/>	<input type="checkbox"/>	<input type="checkbox"/>	<input type="checkbox"/>	<input type="checkbox"/>	<input type="checkbox"/>	<input type="checkbox"/>	<input type="checkbox"/>
		<input type="checkbox"/>	<input type="checkbox"/>	<input type="checkbox"/>	<input type="checkbox"/>	<input type="checkbox"/>	<input type="checkbox"/>	<input type="checkbox"/>	<input type="checkbox"/>	<input type="checkbox"/>
		<input type="checkbox"/>	<input type="checkbox"/>	<input type="checkbox"/>	<input type="checkbox"/>	<input type="checkbox"/>	<input type="checkbox"/>	<input type="checkbox"/>	<input type="checkbox"/>	<input type="checkbox"/>
		<input type="checkbox"/>	<input type="checkbox"/>	<input type="checkbox"/>	<input type="checkbox"/>	<input type="checkbox"/>	<input type="checkbox"/>	<input type="checkbox"/>	<input type="checkbox"/>	<input type="checkbox"/>
		<input type="checkbox"/>	<input type="checkbox"/>	<input type="checkbox"/>	<input type="checkbox"/>	<input type="checkbox"/>	<input type="checkbox"/>	<input type="checkbox"/>	<input type="checkbox"/>	<input type="checkbox"/>
		<input type="checkbox"/>	<input type="checkbox"/>	<input type="checkbox"/>	<input type="checkbox"/>	<input type="checkbox"/>	<input type="checkbox"/>	<input type="checkbox"/>	<input type="checkbox"/>	<input type="checkbox"/>
		<input type="checkbox"/>	<input type="checkbox"/>	<input type="checkbox"/>	<input type="checkbox"/>	<input type="checkbox"/>	<input type="checkbox"/>	<input type="checkbox"/>	<input type="checkbox"/>	<input type="checkbox"/>
		<input type="checkbox"/>	<input type="checkbox"/>	<input type="checkbox"/>	<input type="checkbox"/>	<input type="checkbox"/>	<input type="checkbox"/>	<input type="checkbox"/>	<input type="checkbox"/>	<input type="checkbox"/>
		<input type="checkbox"/>	<input type="checkbox"/>	<input type="checkbox"/>	<input type="checkbox"/>	<input type="checkbox"/>	<input type="checkbox"/>	<input type="checkbox"/>	<input type="checkbox"/>	<input type="checkbox"/>
		<input type="checkbox"/>	<input type="checkbox"/>	<input type="checkbox"/>	<input type="checkbox"/>	<input type="checkbox"/>	<input type="checkbox"/>	<input type="checkbox"/>	<input type="checkbox"/>	<input type="checkbox"/>
		<input type="checkbox"/>	<input type="checkbox"/>	<input type="checkbox"/>	<input type="checkbox"/>	<input type="checkbox"/>	<input type="checkbox"/>	<input type="checkbox"/>	<input type="checkbox"/>	<input type="checkbox"/>
		<input type="checkbox"/>	<input type="checkbox"/>	<input type="checkbox"/>	<input type="checkbox"/>	<input type="checkbox"/>	<input type="checkbox"/>	<input type="checkbox"/>	<input type="checkbox"/>	<input type="checkbox"/>
		<input type="checkbox"/>	<input type="checkbox"/>	<input type="checkbox"/>	<input type="checkbox"/>	<input type="checkbox"/>	<input type="checkbox"/>	<input type="checkbox"/>	<input type="checkbox"/>	<input type="checkbox"/>
		<input type="checkbox"/>	<input type="checkbox"/>	<input type="checkbox"/>	<input type="checkbox"/>	<input type="checkbox"/>	<input type="checkbox"/>	<input type="checkbox"/>	<input type="checkbox"/>	<input type="checkbox"/>
		<input type="checkbox"/>	<input type="checkbox"/>	<input type="checkbox"/>	<input type="checkbox"/>	<input type="checkbox"/>	<input type="checkbox"/>	<input type="checkbox"/>	<input type="checkbox"/>	<input type="checkbox"/>
		<input type="checkbox"/>	<input type="checkbox"/>	<input type="checkbox"/>	<input type="checkbox"/>	<input type="checkbox"/>	<input type="checkbox"/>	<input type="checkbox"/>	<input type="checkbox"/>	<input type="checkbox"/>
		<input type="checkbox"/>	<input type="checkbox"/>	<input type="checkbox"/>	<input type="checkbox"/>	<input type="checkbox"/>	<input type="checkbox"/>	<input type="checkbox"/>	<input type="checkbox"/>	<input type="checkbox"/>
		<input type="checkbox"/>	<input type="checkbox"/>	<input type="checkbox"/>	<input type="checkbox"/>	<input type="checkbox"/>	<input type="checkbox"/>	<input type="checkbox"/>	<input type="checkbox"/>	<input type="checkbox"/>
		<input type="checkbox"/>	<input type="checkbox"/>	<input type="checkbox"/>	<input type="checkbox"/>	<input type="checkbox"/>	<input type="checkbox"/>	<input type="checkbox"/>	<input type="checkbox"/>	<input type="checkbox"/>
		<input type="checkbox"/>	<input type="checkbox"/>	<input type="checkbox"/>	<input type="checkbox"/>	<input type="checkbox"/>	<input type="checkbox"/>	<input type="checkbox"/>	<input type="checkbox"/>	<input type="checkbox"/>
		<input type="checkbox"/>	<input type="checkbox"/>	<input type="checkbox"/>	<input type="checkbox"/>	<input type="checkbox"/>	<input type="checkbox"/>	<input type="checkbox"/>	<input type="checkbox"/>	<input type="checkbox"/>
		<input type="checkbox"/>	<input type="checkbox"/>	<input type="checkbox"/>	<input type="checkbox"/>	<input type="checkbox"/>	<input type="checkbox"/>	<input type="checkbox"/>	<input type="checkbox"/>	<input type="checkbox"/>
		<input type="checkbox"/>	<input type="checkbox"/>	<input type="checkbox"/>	<input type="checkbox"/>	<input type="checkbox"/>	<input type="checkbox"/>	<input type="checkbox"/>	<input type="checkbox"/>	<input type="checkbox"/>
		<input type="checkbox"/>	<input type="checkbox"/>	<input type="checkbox"/>	<input type="checkbox"/>	<input type="checkbox"/>	<input type="checkbox"/>	<input type="checkbox"/>	<input type="checkbox"/>	<input type="checkbox"/>
		<input type="checkbox"/>	<input type="checkbox"/>	<input type="checkbox"/>	<input type="checkbox"/>	<input type="checkbox"/>	<input type="checkbox"/>	<input type="checkbox"/>	<input type="checkbox"/>	<input type="checkbox"/>
		<input type="checkbox"/>	<input type="checkbox"/>	<input type="checkbox"/>	<input type="checkbox"/>	<input type="checkbox"/>	<input type="checkbox"/>	<input type="checkbox"/>	<input type="checkbox"/>	<input type="checkbox"/>
		<input type="checkbox"/>	<input type="checkbox"/>	<input type="checkbox"/>	<input type="checkbox"/>	<input type="checkbox"/>	<input type="checkbox"/>	<input type="checkbox"/>	<input type="checkbox"/>	<input type="checkbox"/>
		<input type="checkbox"/>	<input type="checkbox"/>	<input type="checkbox"/>	<input type="checkbox"/>	<input type="checkbox"/>	<input type="checkbox"/>	<input type="checkbox"/>	<input type="checkbox"/>	<input type="checkbox"/>
		<input type="checkbox"/>	<input type="checkbox"/>	<input type="checkbox"/>	<input type="checkbox"/>	<input type="checkbox"/>	<input type="checkbox"/>	<input type="checkbox"/>	<input type="checkbox"/>	<input type="checkbox"/>
		<input type="checkbox"/>	<input type="checkbox"/>	<input type="checkbox"/>	<input type="checkbox"/>	<input type="checkbox"/>	<input type="checkbox"/>	<input type="checkbox"/>	<input type="checkbox"/>	<input type="checkbox"/>
		<input type="checkbox"/>	<input type="checkbox"/>	<input type="checkbox"/>	<input type="checkbox"/>	<input type="checkbox"/>	<input type="checkbox"/>	<input type="checkbox"/>	<input type="checkbox"/>	<input type="checkbox"/>
		<input type="checkbox"/>	<input type="checkbox"/>	<input type="checkbox"/>	<input type="checkbox"/>	<input type="checkbox"/>	<input type="checkbox"/>	<input type="checkbox"/>	<input type="checkbox"/>	<input type="checkbox"/>
		<input type="checkbox"/>	<input type="checkbox"/>	<input type="checkbox"/>	<input type="checkbox"/>	<input type="checkbox"/>	<input type="checkbox"/>	<input type="checkbox"/>	<input type="checkbox"/>	<input type="checkbox"/>
		<input type="checkbox"/>	<input type="checkbox"/>	<input type="checkbox"/>	<input type="checkbox"/>	<input type="checkbox"/>	<input type="checkbox"/>	<input type="checkbox"/>	<input type="checkbox"/>	<input type="checkbox"/>
		<input type="checkbox"/>	<input type="checkbox"/>	<input type="checkbox"/>	<input type="checkbox"/>	<input type="checkbox"/>	<input type="checkbox"/>	<input type="checkbox"/>	<input type="checkbox"/>	<input type="checkbox"/>
		<input type="checkbox"/>	<input type="checkbox"/>	<input type="checkbox"/>	<input type="checkbox"/>	<input type="checkbox"/>	<input type="checkbox"/>	<input type="checkbox"/>	<input type="checkbox"/>	<input type="checkbox"/>
		<input type="checkbox"/>	<input type="checkbox"/>	<input type="checkbox"/>	<input type="checkbox"/>	<input type="checkbox"/>	<input type="checkbox"/>	<input type="checkbox"/>	<input type="checkbox"/>	<input type="checkbox"/>
		<input type="checkbox"/>	<input type="checkbox"/>	<input type="checkbox"/>	<input type="checkbox"/>	<input type="checkbox"/>	<input type="checkbox"/>	<input type="checkbox"/>	<input type="checkbox"/>	<input type="checkbox"/>
		<input type="checkbox"/>	<input type="checkbox"/>	<input type="checkbox"/>	<input type="checkbox"/>	<input type="checkbox"/>	<input type="checkbox"/>	<input type="checkbox"/>	<input type="checkbox"/>	<input type="checkbox"/>
		<input type="checkbox"/>	<input type="checkbox"/>	<input type="checkbox"/>	<input type="checkbox"/>	<input type="checkbox"/>	<input type="checkbox"/>	<input type="checkbox"/>	<input type="checkbox"/>	<input type="checkbox"/>
		<input type="checkbox"/>	<input type="checkbox"/>	<input type="checkbox"/>	<input type="checkbox"/>	<input type="checkbox"/>	<input type="checkbox"/>	<input type="checkbox"/>	<input type="checkbox"/>	<input type="checkbox"/>
		<input type="checkbox"/>	<input type="checkbox"/>	<input type="checkbox"/>	<input type="checkbox"/>	<input type="checkbox"/>	<input type="checkbox"/>	<input type="checkbox"/>	<input type="checkbox"/>	<input type="checkbox"/>
		<input type="checkbox"/>	<input type="checkbox"/>	<input type="checkbox"/>	<input type="checkbox"/>	<input type="checkbox"/>	<input type="checkbox"/>	<input type="checkbox"/>	<input type="checkbox"/>	<input type="checkbox"/>
		<input type="checkbox"/>	<input type="checkbox"/>	<input type="checkbox"/>	<input type="checkbox"/>	<input type="checkbox"/>	<input type="checkbox"/>	<input type="checkbox"/>	<input type="checkbox"/>	<input type="checkbox"/>
		<input type="checkbox"/>	<input type="checkbox"/>	<input type="checkbox"/>	<input type="checkbox"/>	<input type="checkbox"/>	<input type="checkbox"/>	<input type="checkbox"/>	<input type="checkbox"/>	<input type="checkbox"/>
		<input type="checkbox"/>	<input type="checkbox"/>	<input type="checkbox"/>	<input type="checkbox"/>	<input type="checkbox"/>	<input type="checkbox"/>	<input type="checkbox"/>	<input type="checkbox"/>	<input type="checkbox"/>
		<input type="checkbox"/>	<input type="checkbox"/>	<input type="checkbox"/>	<input type="checkbox"/>	<input type="checkbox"/>	<input type="checkbox"/>	<input type="checkbox"/>	<input type="checkbox"/>	<input type="checkbox"/>
		<input type="checkbox"/>	<input type="checkbox"/>	<input type="checkbox"/>	<input type="checkbox"/>	<input type="checkbox"/>	<input type="checkbox"/>	<input type="checkbox"/>	<input type="checkbox"/>	<input type="checkbox"/>
		<input type="checkbox"/>	<input type="checkbox"/>	<input type="checkbox"/>	<input type="checkbox"/>	<input type="checkbox"/>	<input type="checkbox"/>	<input type="checkbox"/>	<input type="checkbox"/>	<input type="checkbox"/>
		<input type="checkbox"/>	<input type="checkbox"/>	<input type="checkbox"/>	<input type="checkbox"/>	<input type="checkbox"/>	<input type="checkbox"/>	<input type="checkbox"/>	<input type="checkbox"/>	<input type="checkbox"/>
		<input type="checkbox"/>	<input type="checkbox"/>	<input type="checkbox"/>	<input type="checkbox"/>	<input type="checkbox"/>	<input type="checkbox"/>	<input type="checkbox"/>	<input type="checkbox"/>	<input type="checkbox"/>
		<input type="checkbox"/>	<input type="checkbox"/>	<input type="checkbox"/>	<input type="checkbox"/>	<input type="checkbox"/>	<input type="checkbox"/>	<input type="checkbox"/>	<input type="checkbox"/>	<input type="checkbox"/>
		<input type="checkbox"/>	<input type="checkbox"/>	<input type="checkbox"/>	<input type="checkbox"/>	<input type="checkbox"/>	<input type="checkbox"/>	<input type="checkbox"/>	<input type="checkbox"/>	<input type="checkbox"/>
		<input type="checkbox"/>	<input type="checkbox"/>	<input type="checkbox"/>	<input type="checkbox"/>	<input type="checkbox"/>	<input type="checkbox"/>	<input type="checkbox"/>	<input type="checkbox"/>	<input type="checkbox"/>
		<input type="checkbox"/>	<input type="checkbox"/>	<input type="checkbox"/>	<input type="checkbox"/>	<input type="checkbox"/>	<input type="checkbox"/>	<input type="checkbox"/>	<input type="checkbox"/>	<input type="checkbox"/>
		<input type="checkbox"/>	<input type="checkbox"/>	<input type="checkbox"/>						

## Notice of Intent (NOI) for coverage under Small MS4 General Permit

### Part III: Stormwater Management Program Summary

Identify the Best Management Practices (BMPs) that will be employed to address each of the six Minimum Control Measures (MCMs). For municipalities/organizations whose MS4 discharges into a receiving water with an approved Total Maximum Daily Load (TMDL) and an applicable waste load allocation (WLA), identify any additional BMPs employed to specifically support the achievement of the WLA in the TMDL section at the end of part III.

For each MCM, list each existing or proposed BMP by category and provide a brief description, responsible parties/departments, measurable goals, and the year the BMP will be employed (public education and outreach BMPs also requires a target audience). **Use the drop-down menus in each table or enter your own text to override the drop down menu.**

#### MCM 1: Public Education and Outreach

<b>BMP Media/Category</b> (enter your own text to override the drop down menu)	<b>BMP Description</b>	<b>Targeted Audience</b>	<b>Responsible Department/Parties</b> (enter your own text to override the drop down menu)	<b>Measurable Goal</b>	<b>Beginning Year of BMP Implementation</b>
Brochures/Pamphlets	Develop and distribute residential Stormwater Pollution Prevention brochure.	Residents	DPW Operations	Brochures distributed to all water/sewer account holders.	2018
Web Page	Develop and publish fact sheet on Stormwater Pollution Prevention for Businesses/Institutions/Commercial Facilities	Businesses, Institutions and Commercial Facilities	DPW Operations	Publish on Town website. Number of views.	2019
Brochures/Pamphlets	Develop and publish fact sheet and checklists to educate developers on how to comply with Town's Stormwater bylaw, regulations, and permitting procedures. Continue to send (by inclusion in the packet) a standard letter for developments which includes language on stormwater compliance in new & redevelopment.	Developers (construction)	DPW Operations	Number of fact sheets/checklists handed out to development / redevelopment project proponents.	2018

Web Page	Develop and publish fact sheet on Stormwater Pollution Prevention for Industrial Sites.	Industrial Facilities	DPW Operations	Published on Town's website. Number of views.	2019
School Curricula/Programs	Utilize MWRA School Outreach Program for 1 classroom presentation on stormwater in each elementary school.	Residents	DPW Operations	4 classroom presentations on stormwater (4 elementary schools)	2021
Brochures/Pamphlets	Develop and distribute a pamphlet on property management and snow removal/deicing best practices to businesses registered with the Chamber of Commerce.	Businesses, Institutions and Commercial Facilities	DPW Operations	Distribute brochures to businesses registered with Saugus Chamber of Commerce.	2021
Brochures/Pamphlets	Develop and distribute a pamphlet on Low Impact Development to development/redevelopment project proponents in town.	Developers (construction)	DPW Construction	Number of brochures handed out to development / redevelopment project proponents.	2020
Newspaper Articles/Press Releases	Auto Repair / Maintenance shops stormwater pollution prevention press release.	Industrial Facilities	DPW Operations	Number of stories run. Number of views on website.	2021
Brochures/Pamphlets	Pet Waste Brochure distributed annually to dog owners at the time of license renewal. (Bacteria TMDL)	Residents	DPW Operations	Number of dog licenses / brochures distributed.	2019
Brochures/Pamphlets	Septic System Maintenance Brochure distributed to septic system owners. (Bacteria TMDL)	Residents	DPW Operations	Number of septic system owners / brochures distributed.	2019



# Notice of Intent (NOI) for coverage under Small MS4 General Permit

### Part III: Stormwater Management Program Summary (continued)

## MCM 2: Public Involvement and Participation

[illegible]







## Notice of Intent (NOI) for coverage under Small MS4 General Permit

### Part III: Stormwater Management Program Summary *(continued)*

#### MCM 3: Illicit Discharge Detection and Elimination (IDDE)

<b>BMP Categorization</b> (enter your own text to override the drop down menu)	<b>BMP Description</b>	<b>Responsible Department/Parties</b> (enter your own text to override the drop down menu)	<b>Measurable Goal</b> (all text can be overwritten)	<b>Beginning Year of BMP Implementation</b>
SSO inventory	Develop SSO inventory in accordance of permit conditions	DPW Operations	Complete within 1 year of effective date of permit	2019
Storm sewer system map	Continue to update GIS mapping periodically and during IDDE program work	DPW Operations	Update map within 2 years of effective date of permit and complete full system map 10 years after effective date of permit	2019
Written IDDE program	Create written IDDE program	DPW Operations	Complete within 1 year of the effective date of permit and update as required	2018
Implement IDDE program	Implement catchment investigations according to program and permit conditions	DPW Operations	Complete 10 years after effective date of permit	2019
Employee training	Train employees on IDDE implementation	DPW Operations	Train annually	2019
Conduct dry weather screening	Conduct in accordance with outfall screening procedure and permit conditions	DPW Operations	Complete 3 years after effective date of permit	2019
Conduct wet weather screening	Conduct in accordance with outfall screening procedure	DPW Operations	Complete 10 years after effective date of permit	2020
Ongoing screening	Conduct dry weather and wet weather screening (as necessary)	DPW Operations	Complete ongoing outfall screening upon completion of IDDE program	2021



## Notice of Intent (NOI) for coverage under Small MS4 General Permit

### Part III: Stormwater Management Program Summary (continued)

#### MCM 4: Construction Site Stormwater Runoff Control

<b>BMP Categorization</b> (enter your own text to override the drop down menu or entered text)	<b>BMP Description</b>	<b>Responsible Department/Parties</b> (enter your own text to override the drop down menu)	<b>Measurable Goal</b> (all text can be overwritten)	<b>Beginning Year of BMP Implementation</b>
Site inspection and enforcement of Erosion and Sediment Control (ESC) measures	Complete written procedures of site inspections and enforcement procedures	DPW Operations	Complete within 1 year of the effective date of permit	2018
Site plan review	Complete written procedures of site plan review and begin implementation. Continue to work with Planning Board, Inspection Services and Conservation Commission to review site plans for SW impact.	DPW Operations	Develop protocol for site plan review.	2018
Erosion and Sediment Control	Adoption of requirements for construction operators to implement a sediment and erosion control program. Continue to work with Planning Board, Inspection Services and Conservation Commission to review and inspect sites.	DPW Operations	Number of inspections conducted.	2018
Waste Control	Adoption of requirements to control wastes, including but not limited to, discarded building materials, concrete truck wash out, chemicals, litter, and sanitary wastes	DPW Operations	Complete within 1 year of the effective date of permit	2018



## Notice of Intent (NOI) for coverage under Small MS4 General Permit

### Part III: Stormwater Management Program Summary (continued)

#### MCM 5: Post-Construction Stormwater Management in New Development and Redevelopment

<b>BMP Categorization</b> (enter your own text to override the drop down menu or entered text)	<b>BMP Description</b>	<b>Responsible Department/Parties</b> (enter your own text to override the drop down menu)	<b>Measurable Goal</b> (all text can be overwritten)	<b>Beginning Year of BMP Implementation</b>
As-built plans for on-site stormwater control	The procedures to require submission of as-built drawings and ensure long term operation and maintenance will be a part of the SWMP	DPW Operations	Require submission of as-built plans for completed projects	2018
Target properties to reduce impervious areas	Identify at least 5 permittee-owned properties that could be modified or retrofitted with BMPs to reduce impervious areas and update annually	DPW Operations	Complete 4 years after effective date of permit and report annually on retrofitted properties	2021
Allow green infrastructure	Develop a report assessing existing local regulations to determine the feasibility of making green infrastructure practices allowable when appropriate site conditions exist	DPW Operations	Complete 4 years after effective date of permit and implement recommendations of report	2021
Street design and parking lot guidelines	Develop a report assessing requirements that affect the creation of impervious cover. The assessment will help determine if changes to design standards for streets and parking lots can be modified to support low impact design options.	DPW Operations	Complete 4 years after effective date of permit and implement recommendations of report	2021

[illegible]

## Notice of Intent (NOI) for coverage under Small MS4 General Permit

### Part III: Stormwater Management Program Summary *(continued)*

#### MCM 6: Municipal Good Housekeeping and Pollution Prevention

<b>BMP Categorization</b> (enter your own text to override the drop down menu or entered text)	<b>BMP Description</b>	<b>Responsible Department/Parties</b> (enter your own text to override the drop down menu)	<b>Measurable Goal</b> (all text can be overwritten)	<b>Beginning Year of BMP Implementation</b>
O&M procedures	Create written O&M procedures including all requirements contained in 2.3.7.a.ii for parks and open spaces, buildings and facilities, and vehicles and equipment	DPW Operations	Complete and implement 2 years after effective date of permit	2019
Inventory all permittee-owned parks and open spaces, buildings and facilities, and vehicles and equipment	Create inventory	DPW Operations	Complete 2 years after effective date of permit and implement annually	2019
Infrastructure O&M	Establish and implement program for repair and rehabilitation of MS4 infrastructure.	DPW Operations	Complete 2 years after effective date of permit	2019
Stormwater Pollution Prevention Plan (SWPPP)	Create SWPPPs for maintenance garages, transfer stations, and other waste-handling facilities	DPW Operations	Complete and implement 2 years after effective date of permit	2019
Catch basin cleaning	Establish schedule for catch basin cleaning such that each catch basin is no more than 50% full and clean catch basins on that schedule	DPW Operations	Clean catch basins on established schedule and report number of catch basins cleaned and volume of material moved annually	2018
Street sweeping program	Continue to sweep all streets and permittee-owned parking lots twice each year, in accordance with permit conditions	DPW Operations	Continue to sweep all streets and permittee-owned parking lots twice per year	2018









--	--	--	--	--

**Part IV: Notes and additional information**

Use the space below to indicate the part(s) of 2.2.1 and 2.2.2 that you have identified as not applicable to your MS4 because you do not discharge to the impaired water body or a tributary to an impaired water body due to nitrogen or phosphorus. Provide all supporting documentation below or attach additional documents if necessary. Also, provide any additional information about your MS4 program below.

Saugus is subject to a TMDL for pathogens. Saugus is not located in watersheds with TMDLs for phosphorus or nitrogen, nor are the waters impaired for Phosphorus or Nitrogen.

Correspondence on Endangered Species Act eligibility is attached.

## Notice of Intent (NOI) for coverage under Small MS4 General Permit

Page 21 of 21

### Part V: Certification

*I certify under penalty of law that this document and all attachments were prepared under my direction or supervision in accordance with a system designed to assure that qualified personnel properly gather and evaluate the information submitted. Based on my inquiry of the person or persons who manage the system, or those persons directly responsible for gathering the information, I certify that the information submitted is, to the best of my knowledge and belief, true, accurate, and complete. I am aware that there are significant penalties for submitting false information, including the possibility of fine and imprisonment for knowing violations.*

Name:

Scott C. Crabtree

Title:

Town Manager

Signature:

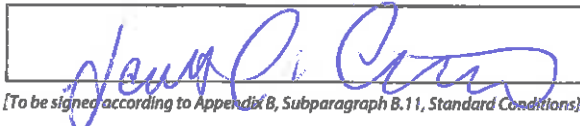
  
[To be signed according to Appendix B, Subparagraph B.11, Standard Conditions]

Date:

9/25/18

**Note:** When prompted during signing, save the document under a new file name



# United States Department of the Interior

## FISH AND WILDLIFE SERVICE



New England Field Office  
70 Commercial St, Suite 300  
Concord, NH 03301-5087  
<http://www.fws.gov/newengland>

September 24, 2018

To whom it may concern:

The U.S. Fish and Wildlife Service (USFWS) reviewed the stormwater discharge activities associated with the 2016 National Pollutant Discharge and Elimination System (NPDES) Massachusetts (MA) Small Municipal Separate Storm Sewer System (MS4) general permit (MA MS4 General Permit) issued by the Environmental Protection Agency (EPA). We determined those activities may affect, but are not likely to adversely affect, certain species listed under the Endangered Species Act (ESA) of 1973 (87 Stat. 884, as amended; 16 U.S.C. 1531 *et seq.*) when specific conditions are met. When these conditions are met, we do not need to review individual projects. These comments are provided in accordance with section 7 of the ESA and complement existing 2016 MA MS4 General Permit Appendix C Guidance. We understand the applicant is acting as a non-Federal representative of the EPA for the purpose of consultation under section 7. **This letter provides additional guidance for meeting Criterion B and should be submitted as part of your application package to the EPA.**

If the USFWS Information for Planning and Consultation website (<https://ecos.fws.gov/ipac/>) indicates your MA MS4 General Permit project action area may contain one or more of the following federally listed endangered species: roseate tern (*Sterna dougallii*), northern red-bellied cooter (*Pseudemys rubriventris*), dwarf wedgemussel (*Alasmidonta heterodon*), rusty patched bumble bee (*Bombus affinis*), northeastern bulrush (*Scirpus ancistrochaetus*), or American chaffseed (*Schwalbea americana*); threatened species: piping plover (*Charadrius melodus*), bog turtle (*Glyptemys muhlenbergii*), Puritan tiger beetle (*Cicindela puritana*), northeastern beach tiger beetle (*Cicindela dorsalis*), or red knot (*Calidris canutus rufa*); or their federally designated critical habitat; and the specific conditions listed below are met, you may submit this letter to complete the **MA MS4 General Permit Appendix C: Step 4** in place of a concurrence letter for informal consultation as documentation of ESA eligibility for **USFWS Criterion B**.

In addition, this letter also satisfies the requirement in the **MA MS4 General Permit Appendix C: Step 2 (3)** to contact the USFWS and obtain a concurrence letter, if you have not yet done so. If your project action area includes one or more of the above-listed species *and* one or more of the



species listed under **Criterion C**,<sup>1</sup> you may still use this letter to certify under **Criterion B**. All existing guidance regarding requirements for certifying eligibility according to the USFWS Criterion A, B, or C for coverage by the 2016 MS4 Permit (see MA MS4 General Permit Appendix C – Endangered Species Guidance) remains unchanged.

We have determined that proposed stormwater discharge activities covered under the 2016 MS4 Permit *may affect, but are not likely to adversely affect*, the above-listed species and the species' critical habitat when the following are true:

1. all stormwater discharges are pre-existing or previously permitted by EPA;
2. any planned operations and maintenance work covered by this permit will only affect previously disturbed areas where stormwater controls are already installed. In these situations the chance of encountering any of the subject species is discountable;
3. the project implements EPA MS4 Best Management Practices (BMPs) and meets Clean Water Act and Massachusetts Water Quality Standards. Although permitted discharges may reach the environment used by these species, BMPs reduce pollutants to the extent that discharges are not known to have measurable impacts on these species or their habitat;
4. no new construction or structural BMPs are proposed under this permit at this time; and
5. you agree that if, during the course of the permit term, you plan to install a structural BMP not identified in the Notice of Intent (NOI), you will re-initiate consultation with the USFWS as necessary (see **MA MS4 General Permit Appendix C: Step 2 (5)**).

If the above criteria are met, further consultation with the USFWS under section 7 of the ESA is not required at this time; however, if the proposed action changes in any way such that it may affect a listed species in a manner not previously analyzed or if new information reveals the presence of additional listed species that may be affected by the project, the applicant or the EPA should contact us immediately and suspend activities that may affect those species until the appropriate level of consultation is completed with our office. Thank you for your cooperation, and please contact David Simmons of this office at (603) 227-6425 if you have questions or need further assistance.

Sincerely yours,

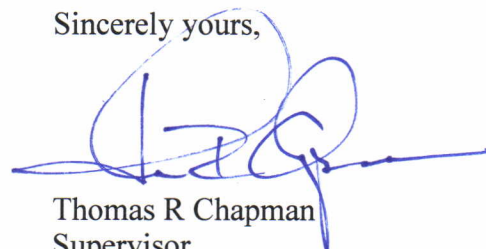

Thomas R Chapman  
Supervisor  
New England Field Office

---

<sup>1</sup> Criterion C includes guidance for project action areas that may contain species for which EPA has already made a determination. These species include the northern long-eared bat (*Myotis septentrionalis*), sandplain gerardia (*Agalinis acuta*), small whorled pogonia (*Isotria medeoloides*), and/or American burying beetle (*Nicrophorus americanus*) (MA MS4 General Permit Appendix C: Step 3 – Determine if You Can Meet Eligibility USFWS Criterion C).

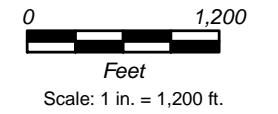
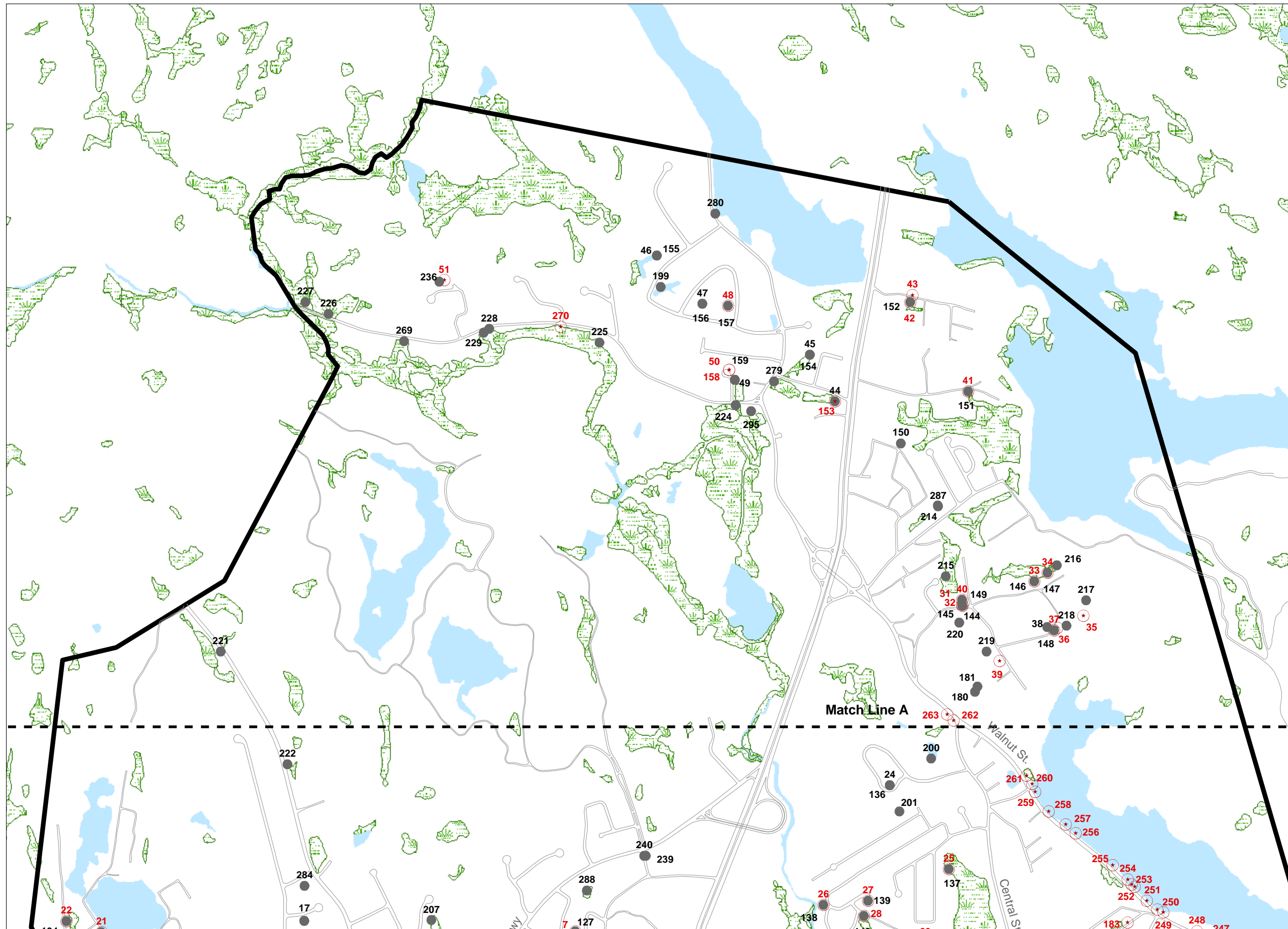

### Legend

- Outfalls
  - Photo Available
  - ⊛ No Photo
- Street Edge
- ▭ Town Boundary
- Open Water
- Wetlands
- - - Match Line

Sheet 1 of 3

**Stormwater Drainage  
System Outfalls**

**Town of Saugus  
Massachusetts**





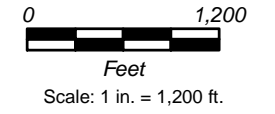
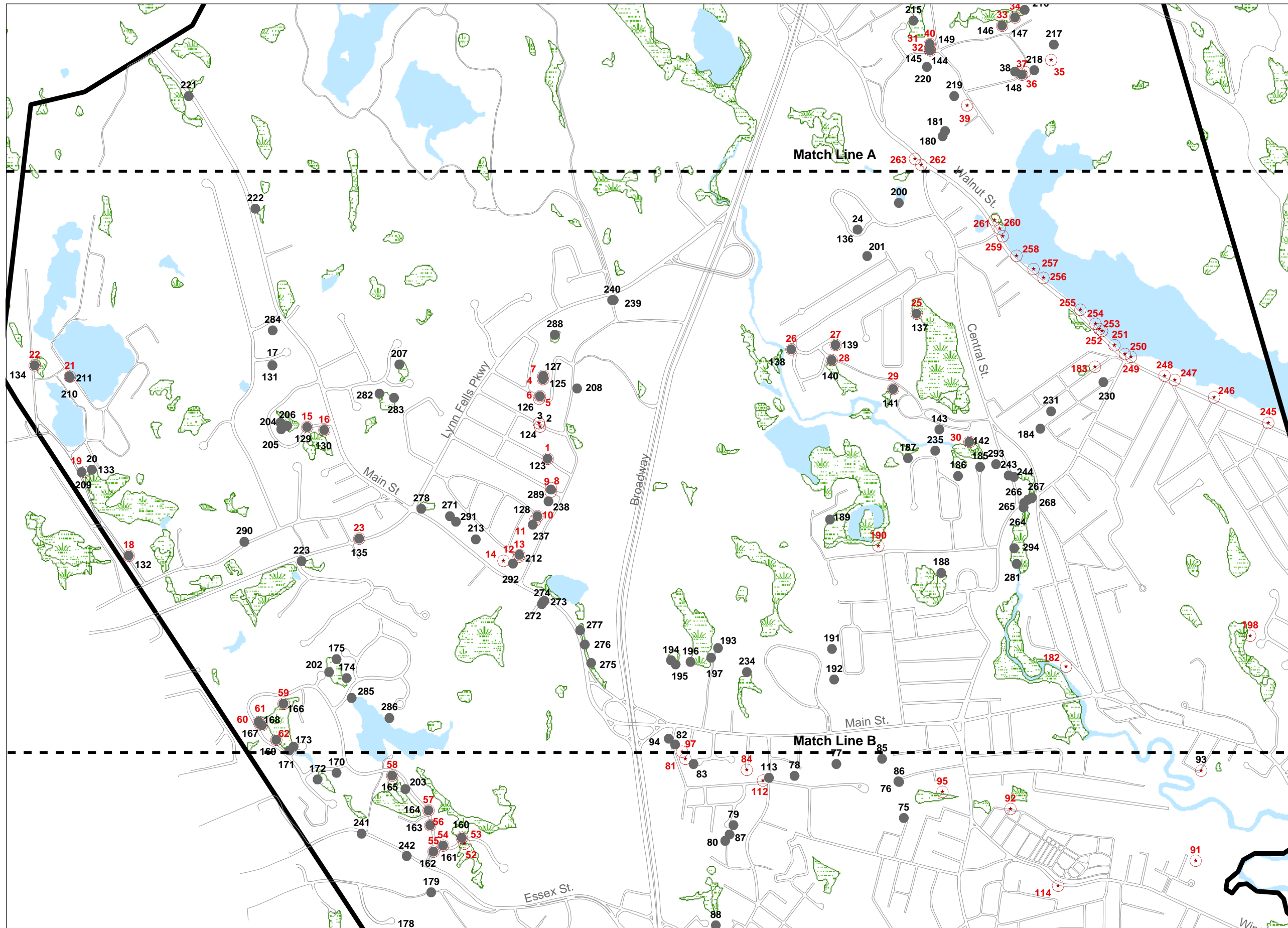

### Legend

- Outfalls
  - Photo Available
  - ★ No Photo
- Street Edge
- ▭ Town Boundary
- Open Water
- Wetlands
- - - Match Line

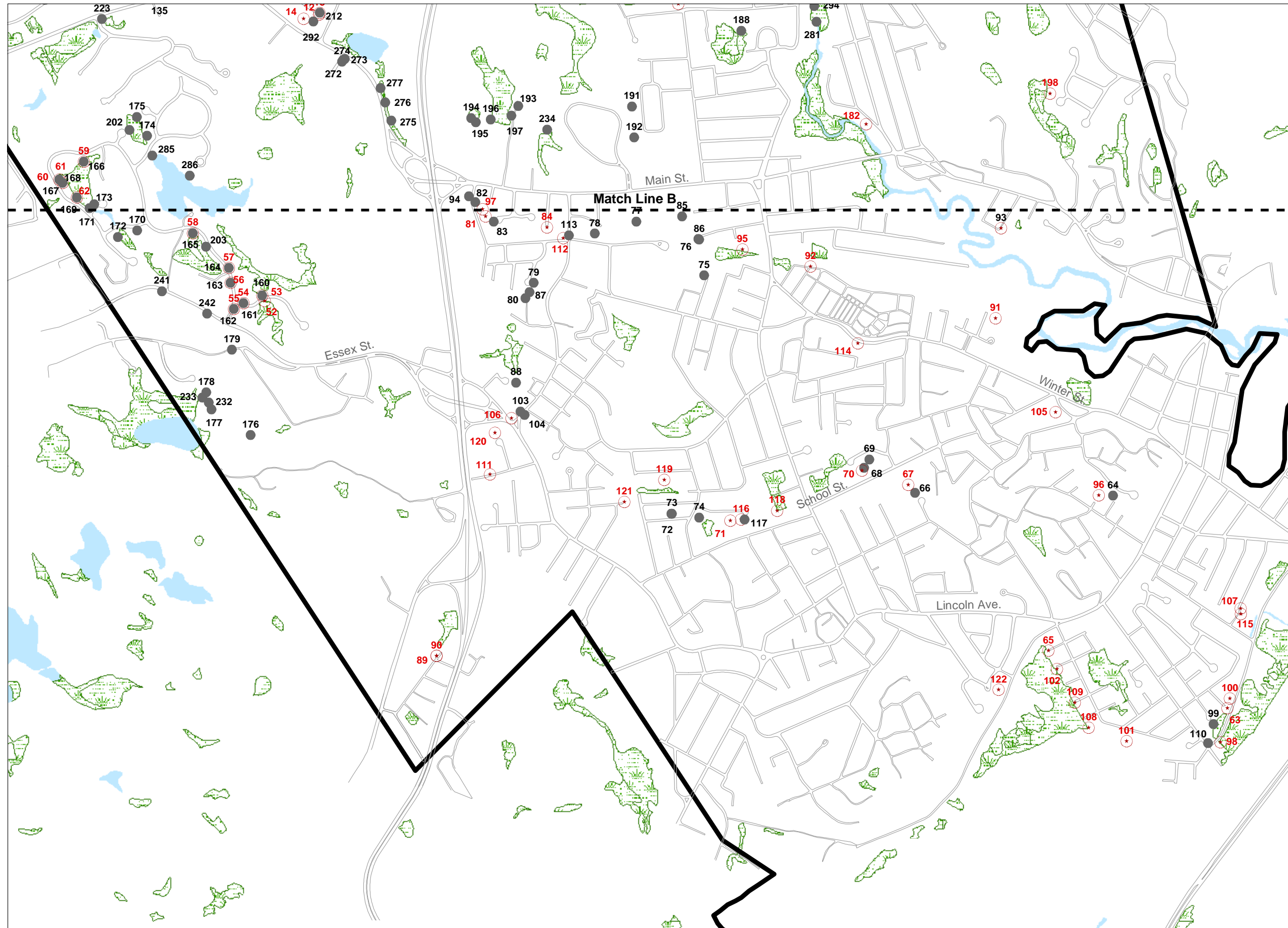

0 1,200  
Feet  
Scale: 1 in. = 1,200 ft.

### Legend

- Outfalls
- Photo Available
  - ★ No Photo
- Street Edge
- ▭ Town Boundary
- Open Water
- ▨ Wetlands
- - - Match Line

Sheet 3 of 3

**Stormwater Drainage  
System Outfalls**

**Town of Saugus  
Massachusetts**







## United States Department of the Interior

FISH AND WILDLIFE SERVICE  
New England Ecological Services Field Office  
70 Commercial Street, Suite 300  
Concord, NH 03301-5094  
Phone: (603) 223-2541 Fax: (603) 223-0104  
<http://www.fws.gov/newengland>



In Reply Refer To:  
Consultation Code: 05E1NE00-2018-SLI-3034  
Event Code: 05E1NE00-2018-E-07157  
Project Name: Saugus MS4 - NOI

September 11, 2018

Subject: List of threatened and endangered species that may occur in your proposed project location, and/or may be affected by your proposed project

### To Whom It May Concern:

The enclosed species list identifies threatened, endangered, proposed and candidate species, as well as proposed and final designated critical habitat, that may occur within the boundary of your proposed project and/or may be affected by your proposed project. The species list fulfills the requirements of the U.S. Fish and Wildlife Service (Service) under section 7(c) of the Endangered Species Act (Act) of 1973, as amended (16 U.S.C. 1531 *et seq.*).

New information based on updated surveys, changes in the abundance and distribution of species, changed habitat conditions, or other factors could change this list. Please feel free to contact us if you need more current information or assistance regarding the potential impacts to federally proposed, listed, and candidate species and federally designated and proposed critical habitat. Please note that under 50 CFR 402.12(e) of the regulations implementing section 7 of the Act, the accuracy of this species list should be verified after 90 days. This verification can be completed formally or informally as desired. The Service recommends that verification be completed by visiting the ECOS-IPaC website at regular intervals during project planning and implementation for updates to species lists and information. An updated list may be requested through the ECOS-IPaC system by completing the same process used to receive the enclosed list.

The purpose of the Act is to provide a means whereby threatened and endangered species and the ecosystems upon which they depend may be conserved. Under sections 7(a)(1) and 7(a)(2) of the Act and its implementing regulations (50 CFR 402 *et seq.*), Federal agencies are required to utilize their authorities to carry out programs for the conservation of threatened and endangered species and to determine whether projects may affect threatened and endangered species and/or designated critical habitat.

A Biological Assessment is required for construction projects (or other undertakings having similar physical impacts) that are major Federal actions significantly affecting the quality of the human environment as defined in the National Environmental Policy Act (42 U.S.C. 4332(2)(c)). For projects other than major construction activities, the Service suggests that a biological evaluation similar to a Biological Assessment be prepared to determine whether the project may affect listed or proposed species and/or designated or proposed critical habitat. Recommended contents of a Biological Assessment are described at 50 CFR 402.12.

If a Federal agency determines, based on the Biological Assessment or biological evaluation, that listed species and/or designated critical habitat may be affected by the proposed project, the agency is required to consult with the Service pursuant to 50 CFR 402. In addition, the Service recommends that candidate species, proposed species and proposed critical habitat be addressed within the consultation. More information on the regulations and procedures for section 7 consultation, including the role of permit or license applicants, can be found in the "Endangered Species Consultation Handbook" at:

<http://www.fws.gov/endangered/esa-library/pdf/TOC-GLOS.PDF>

Please be aware that bald and golden eagles are protected under the Bald and Golden Eagle Protection Act (16 U.S.C. 668 *et seq.*), and projects affecting these species may require development of an eagle conservation plan ([http://www.fws.gov/windenergy/eagle\\_guidance.html](http://www.fws.gov/windenergy/eagle_guidance.html)). Additionally, wind energy projects should follow the wind energy guidelines (<http://www.fws.gov/windenergy/>) for minimizing impacts to migratory birds and bats.

Guidance for minimizing impacts to migratory birds for projects including communications towers (e.g., cellular, digital television, radio, and emergency broadcast) can be found at: <http://www.fws.gov/migratorybirds/CurrentBirdIssues/Hazards/towers/towers.htm>; <http://www.towerkill.com>; and <http://www.fws.gov/migratorybirds/CurrentBirdIssues/Hazards/towers/comtow.html>.

We appreciate your concern for threatened and endangered species. The Service encourages Federal agencies to include conservation of threatened and endangered species into their project planning to further the purposes of the Act. Please include the Consultation Tracking Number in the header of this letter with any request for consultation or correspondence about your project that you submit to our office.

Attachment(s):

- Official Species List
-

## Official Species List

This list is provided pursuant to Section 7 of the Endangered Species Act, and fulfills the requirement for Federal agencies to "request of the Secretary of the Interior information whether any species which is listed or proposed to be listed may be present in the area of a proposed action".

This species list is provided by:

**New England Ecological Services Field Office**  
70 Commercial Street, Suite 300  
Concord, NH 03301-5094  
(603) 223-2541

---



## Project Summary

Consultation Code: 05E1NE00-2018-SLI-3034

Event Code: 05E1NE00-2018-E-07157

Project Name: Saugus MS4 - NOI

Project Type: \*\* OTHER \*\*

Project Description: Ongoing Stormwater Discharges

Project Location:

Approximate location of the project can be viewed in Google Maps: <https://www.google.com/maps/place/42.44859147088435N71.02498122818747W>



Counties: Essex, MA | Middlesex, MA

---

## Endangered Species Act Species

There is a total of 3 threatened, endangered, or candidate species on this species list.

Species on this list should be considered in an effects analysis for your project and could include species that exist in another geographic area. For example, certain fish may appear on the species list because a project could affect downstream species.

IPaC does not display listed species or critical habitats under the sole jurisdiction of NOAA Fisheries<sup>1</sup>, as USFWS does not have the authority to speak on behalf of NOAA and the Department of Commerce.

See the "Critical habitats" section below for those critical habitats that lie wholly or partially within your project area under this office's jurisdiction. Please contact the designated FWS office if you have questions.

- 
1. [NOAA Fisheries](#), also known as the National Marine Fisheries Service (NMFS), is an office of the National Oceanic and Atmospheric Administration within the Department of Commerce.

## Mammals

NAME	STATUS
Northern Long-eared Bat <i>Myotis septentrionalis</i> No critical habitat has been designated for this species. Species profile: <a href="https://ecos.fws.gov/ecp/species/9045">https://ecos.fws.gov/ecp/species/9045</a>	Threatened

## Birds

NAME	STATUS
Red Knot <i>Calidris canutus rufa</i> No critical habitat has been designated for this species. Species profile: <a href="https://ecos.fws.gov/ecp/species/1864">https://ecos.fws.gov/ecp/species/1864</a>	Threatened
Roseate Tern <i>Sterna dougallii dougallii</i> Population: northeast U.S. nesting pop. No critical habitat has been designated for this species. Species profile: <a href="https://ecos.fws.gov/ecp/species/2083">https://ecos.fws.gov/ecp/species/2083</a>	Endangered

## Critical habitats

THERE ARE NO CRITICAL HABITATS WITHIN YOUR PROJECT AREA UNDER THIS OFFICE'S JURISDICTION.

---