

A PLUMBING PERMIT IS REQUIRED PRIOR TO PURCHASE!

TOWN OF SAUGUS WATER METER ORDER FORM

CUSTOMER NAME: _____

PROPERTY LOCATION: _____

ADDRESS (if different) _____

PHONE # _____

CHECK # _____

_____ NEW CONSTRUCTION _____ IRRIGATION _____ REPLACEMENT

TOTAL AMOUNT DUE: _____
(Make checks payable to the Town of Saugus)

_____ 5/8" x3/4" or 5/8" x 1/2" BADGER Model 25 low lead bronze case, cast iron
bottom, polymer register housing with glass lens digital and
100WP-R remote mount ERT \$247.40 each

_____ 3/4" BADGER Model 35 low lead bronze case, cast iron bottom,
Polymer register housing with glass lens digital and 100WP-R
remote mount ERT \$273.30 each

_____ 1" BADGER Model 70 low lead bronze case, cast iron
bottom, polymer register housing with glass lens digital and
100WP-R remote mount ERT \$354.00 each

_____ *1.5" BADGER series in flanged body cubic feet and 100WP-R
remote mount ERT \$663.31 each

_____ *2" BADGER series in flanged body cubic feet with 100WP-R
remote ERT \$807.54 each

_____ *3" BADGER compound round base low lead, bronze case, cast iron
bottom, polymer register housing, glass lens digital and 100WP-R
remote mount ERT \$2,321.00 each

_____ *4" compound round base low lead, bronze case, cast iron,
polymer register housing, glass lens digital and 100WP-R remote
mount ERT \$\$2,664.00 each

*WATER METER SIZES 1.5" AND LARGER ARE SPECIAL ORDERED AND HAVE A SIX WEEK
LEAD TIME. PLEASE ORDER ACCORDINGLY.

IMPORTANT!! ONCE METER IS INSTALLED PLEASE CONTACT THE METER TECHNICIAN AT
781-231-4137 TO TAG AND SEAL THE METER.

TOWN OF SAUGUS

Policy For Second Water Meter Purchase and Installation

Applications must be approved by the Director of Public Works

2. The property owner/contractor shall purchase the second meter from the Town of Saugus Department of Public Works, (781) 231-4145, 515 Main Street, Saugus, MA 01906. The cost of the meter is shown on the attached price list.

3. Before installation of the 2nd meter the entrance fee of \$450.00, made payable to the Town of Saugus, must be paid for each additional meter.

The property owner must have a MA licensed plumber install all necessary plumbing and pull all appropriate plumbing permits. The second will be installed parallel to the domestic water meter so that usage on the second meter does not register on the domestic meter. Any repairs needed to the associated pipes are the responsibility of the property owner.

Any tampering of the meter or transmitting device will result in a fine to the property owner of \$500.00 plus any legal fees.

Once the meter is installed the homeowner and/or plumber must contact the Town of Saugus Treasurer/Collector's Office at (781) 231-4137 to have the meter inspected by the Water Meter Technician and have the new account established.

In addition to the water/sewer bill for water usage registering on the house meter, the property owner will receive a second water bill during each billing cycle based on the usage registered on the second meter. If no usage is registered, the property owner will receive a minimum water charge based on the rates in effect at the time of the billing.

Any repairs/replacement to the second water meter are the responsibility of the homeowner.

I have read, understand and agree to the above policy and regulations:

Property Owner: _____

Address: _____ Phone #: _____

Signature: _____ Date: _____

Plumber: _____ Phone #: _____

Address: _____ MA License #: _____

Public Works Director: _____ Date: _____

Town of Saugus
 Plumbing Department
 298 Central Street
 Saugus, MA 01906

JOB _____
 SHEET NO. _____ OF _____
 CALCULATED BY _____ DATE _____
 CHECKED BY _____ DATE _____
 SCALE _____

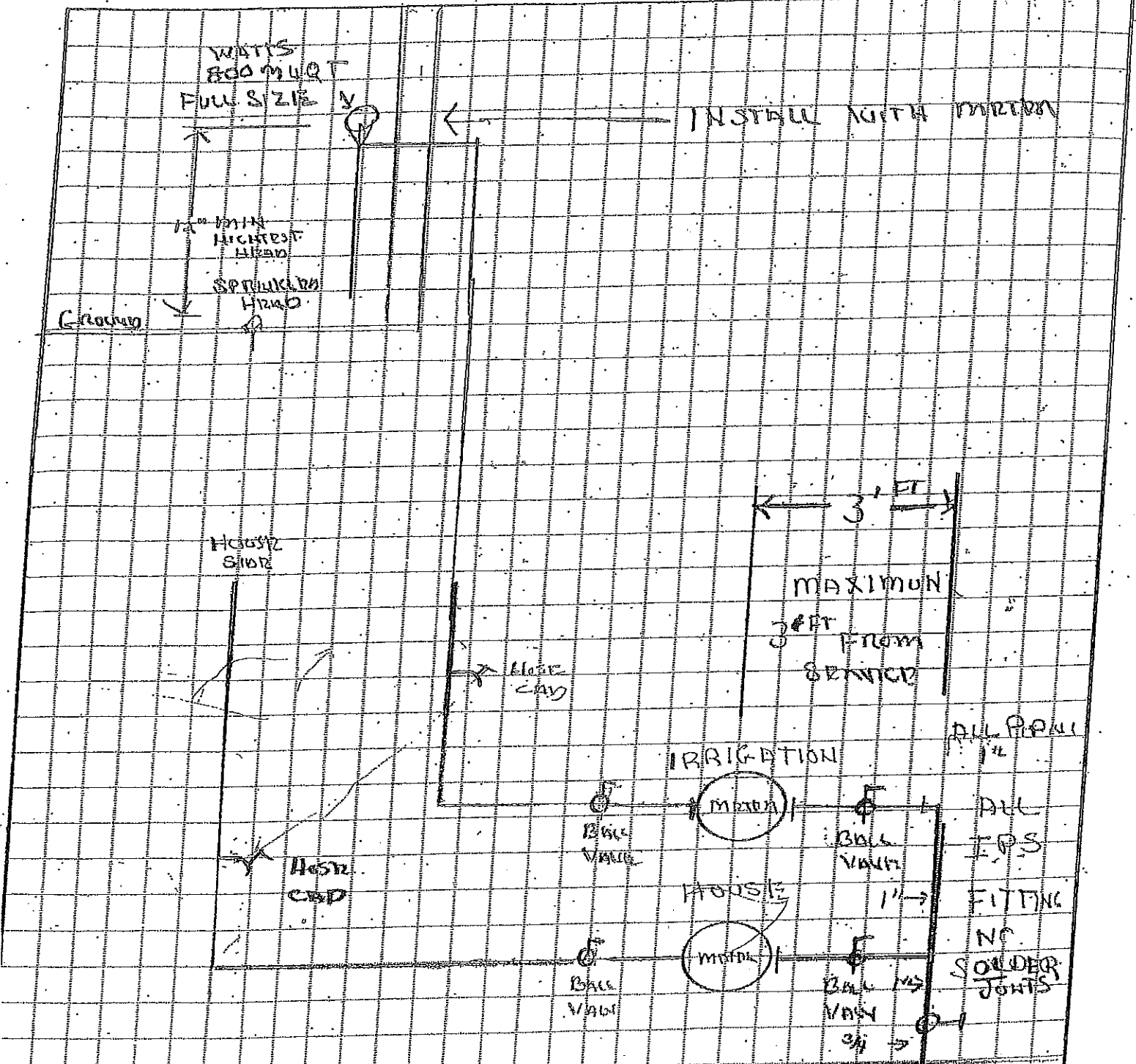

PLUMBING PERMIT REQUIREMENTS

meters have to be installed
 horizontally!!

WATSON
 SHAWMUT

ALL PIPING
 ALL F.P.S.
 FITTING
 NO
 SOLDER
 JOINTS